

# SOMFY INSTRUCTIONS

## DECOFLEX WIREFREE RTS SWITCH

### Part #'S

- 1810897 DecoFlex 1 Channel (white)
- 1810898 DecoFlex 1 Channel (ivory)
- 1810899 DecoFlex 1 Channel (black)
- 1810813 DecoFlex 5 Channel (white)
- 1810814 DecoFlex 5 Channel (ivory)
- 1810830 DecoFlex 5 Channel (black)

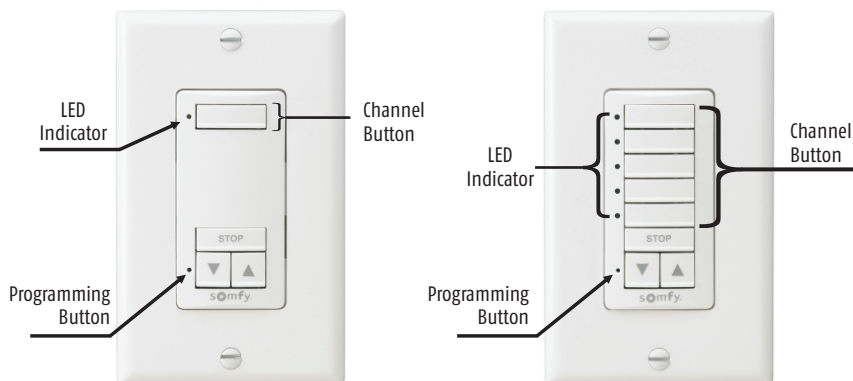

The DecoFlex RTS Switch is a wireless radio transmitter compatible with all Somfy RTS Motors and externally mounted RTS receivers.

- Commands are transmitted by radio waves at 433.42 MHz.
- Operating temperature: +5°C/41°F to +40°C/104°F
- Power: 3V lithium battery, CR 2450 type
- Range: Up to 65 Ft.
- Fits into standard Decora Wall Plates

The Somfy DecoFlex RTS switch is a low voltage device which does not require an electrical box. It can be mounted adjacent to an existing Decora style light switch or as a stand-alone device using the (included) SOMFY low voltage mounting bracket (See installation section for details).

### PROGRAMMING – ADDING A DECOFLEX RTS WALL SWITCH – INITIAL INSTALLATION

**Note:** During initial programming it is recommended to provide power only to the motor or RTS receiver being programmed.

A previously programmed Telis transmitter can be used to add a new DecoFlex RTS Wall Switch to the Motorized Window Covering. If a Telis transmitter has not been previously programmed, please refer to the installation/programming instructions of the relevant RTS motorized window covering.

1. Using the previously programmed Telis remote, press and hold the programming button on back of remote until window covering “jogs.” (“jog” is a brief back and forth movement of the window covering)

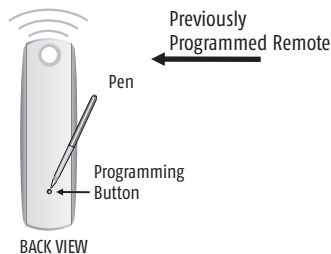

2. Select a channel to be memorized by pressing the appropriate Channel Button. The adjacent LED indicator will illuminate when the channel has been selected.



3. Using a paper clip, or similar device, briefly press the Programming Button (for 1 second) located on the DecoFlex switch until window covering “jogs.” Window covering has now learned the commands of the DecoFlex switch or channel.

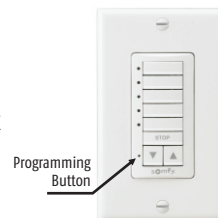

### PROGRAMMING – ADDING ADDITIONAL CHANNELS OR DECOFLEX WALL SWITCHES

1. Using a paper clip, or similar device, press and hold the Programming Button on the previously addressed DecoFlex switch until window covering “jogs.”



2. Select a NEW channel or DecoFlex switch to be memorized by pressing the appropriate Channel Button. The adjacent LED indicator will illuminate when the channel has been selected.

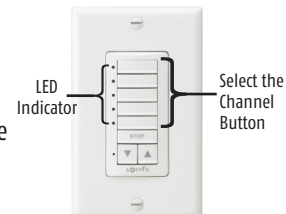

3. Using a paper clip, or similar device, briefly press the Programming Button (for 1 second) located on the DecoFlex switch until window covering “jogs.” Window covering has now learned the commands of the new DecoFlex switch or channel.

## PROGRAMMING – SETTING A FAVORITE OR PREFERRED POSITION

1. Select the Channel Button that has been programmed to a specific window covering. The adjacent LED indicator will illuminate when the channel has been selected.

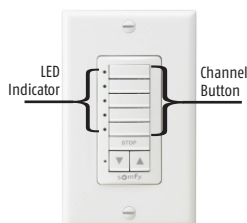

2. Using the UP (▲) or Down (▼) buttons, activate the window covering to a desired position: for example, halfway open or closed. Briefly press the STOP button to stop the window covering when the position is reached.

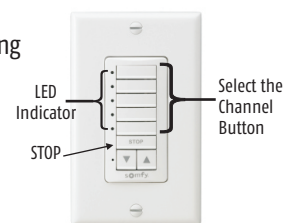

For "Tilt-Activated" window coverings, simply press and hold the UP (▲) or Down (▼) button to reach a preferred position.

3. Press and hold the STOP button until the window covering "jogs." Favorite position is now recorded.



4. Favorite position can now be activated from any previous position. Example: Briefly press the STOP button while window covering is in a Open, Closed, or any non-moving position.

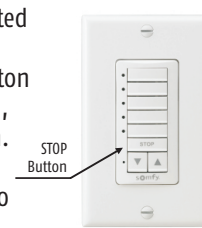

Note: Activating window covering to a favorite position while already "in-motion" will require (2) brief presses of the STOP button.

## PROGRAMMING – DELETING SPECIFIC CHANNELS OR DECOFLEX WALL SWITCH FROM MEMORY

1. Using a paper clip, or similar device, press and hold the Programming Button on a previously addressed DecoFlex switch until window covering "jogs."

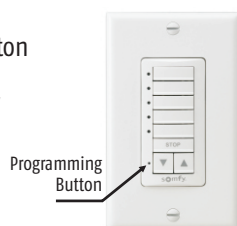

2. Select a channel to be deleted by pressing the appropriate channel Button. The adjacent LED indicator light will illuminate when the channel has been selected.

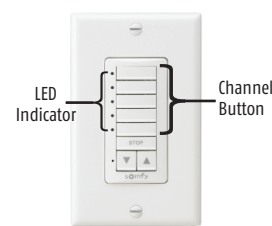

**NOTE: Only one channel can be deleted per procedure. To remove/delete additional channels, proceed to [Step 3](#) then start at [Step 1](#) again for each additional channel to be deleted.**

3. Using a paper clip, or similar device, briefly press the Programming Button (for 1 second) located on the DecoFlex switch until window covering "jogs". The selected channel or new DecoFlex switch is now deleted from the memory of motorized window covering.

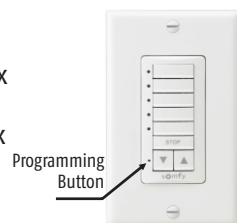

## OPERATING THE DECOFLEX SWITCH

1. Select the Channel Button that has been programmed to a specific window covering.

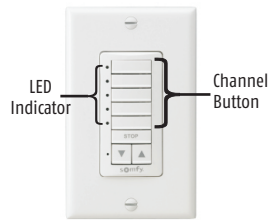

2. To raise or open the window covering, press the UP (▲) button. To lower or close the window covering, press the down (▼) button.

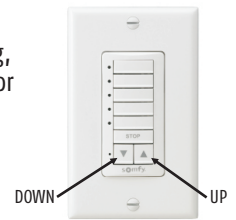

3. To stop the window covering at any time, simply press the STOP button.



**NOTE: If a command button (UP, DOWN, STOP) is pressed without a channel button(s) selected, the DecoFlex™ will default to the channel button(s) previously selected. Selecting multiple CHANNEL BUTTONS for "group" activation will result in a sequential-output whereby each channel will activate in sequence from channel 1-5.**

## INSTALLATION

**Included is a special SOMFY low voltage device mounting bracket which attaches to drywall and eliminates the need for an electrical box. The bracket can be used in two mounting type configurations, they are as follows:**

1. The bracket is specifically designed for mounting the DecoFlex RTS wall switch to an adjacent (pre-existing) Decora style light switch (see below). This unique mounting bracket allows the necessary spacing for 2 adjacent switches and a new "Double Gang" (2 Gang) face/cover plate to be installed (See photo 8) resulting in an aesthetically pleasing professional installation.
2. The bracket can also be used for individual or "stand-alone" (1 switch) mounting configurations when mounting to an adjacent light switch is not necessary.

**Note: When following configuration 1: The mounting bracket is not designed to be used in conjunction with "finished-drywall" or retrofit electrical boxes.**

**Tools required for installation:** Screw drivers (Phillips and Bladed), Dry-wall saw, Wall stud sensor, Non-marring tape and pencil

**Somfy recommends shutting off power to the exposed electrical box prior to installation.**

1. Locate an existing light switch and remove wall plate exposing switch box.



2. Using a stud sensor, locate the stud nearest to exposed electrical box. Then mark (for reference) with removable tape or pencil.

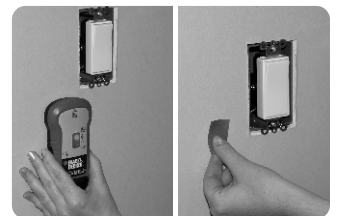

3. Place the flat side of mounting bracket (included) against the wall and align the thin side over the outside edge of the existing electrical box (opposite the stud side). Center the bracket to align the mounting screw height with existing switch, then trace the inside shape of the bracket on wall using a pencil.

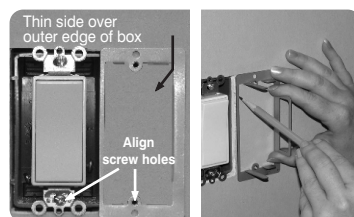

4. Using a dry-wall saw (or similar) begin to cut the dry-wall along the traced outline. Do not cut hole larger than outline as this may result in a loose fitting bracket.

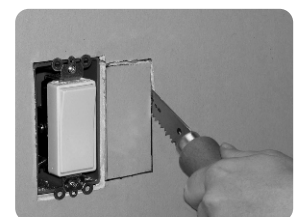

**somfy**

5. Insert bracket (as shown) into hole, **keeping the thin side closest to the edge of the existing switch box.**

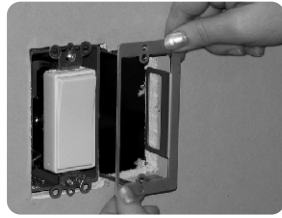

6. Carefully bend bracket tabs 90 degrees behind the dry-wall to ensure a tight secure fit.

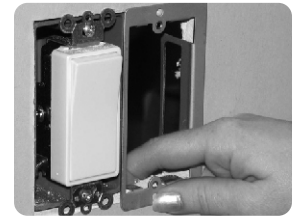

7. Position the DecoFlex RTS switch into mounting bracket aligning the screw holes. Secure switch to mounting bracket with screws (provided).

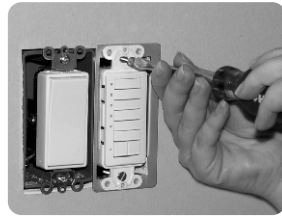

8. Attach a new (2 gang) or double gang Decora style wall plate over both switches to complete installation.

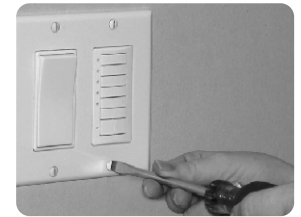

## REPLACING THE BATTERY

The DecoFlex WireFree™ RTS switch is designed to provide years of maintenance free performance. Should the battery need to be replaced, the LED indicator lights will no longer function when the Channel Button is selected or when an Up/Stop/Down command is activated. As a result, the radio signal will be reduced or not communicated to the RTS receiver or motor. The battery can be easily replaced by exposing the Switch Base Assembly board of the DecoFlex WireFree™ switch. Simply slide the battery out of its holder and replace with a new 3V Lithium battery (type 2450) maintaining the correct polarity.

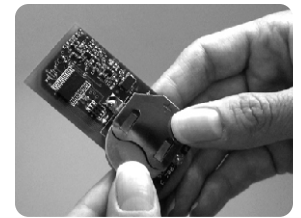

**NOTE: Batteries should be disposed of properly according to local regulations.**

## ASSEMBLE 2, 3, & 4 CHANNEL SWITCHES

1. Begin with a standard (assembled) 1 or 5 channel button DecoFlex switch - Using a small flat blade screw driver, carefully separate the Switch Base Assembly from the Face Plate .

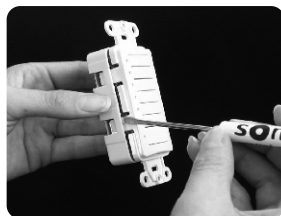

Figure 1.

2. Add or remove Channel Buttons (as required) from the Switch Base Assembly. Be certain the Switch Base Assembly remains intact.

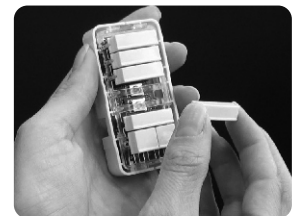

Figure 2.

3. Attach new 2, 3, or 4 channel button face plate.

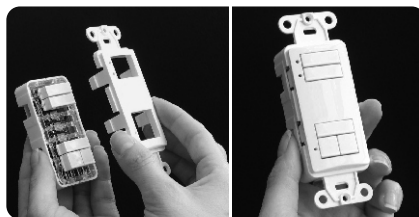

Figure 3 & 4.

### 5 Channel DecoFlex Wall Switch Expanded view

Removable Channel Buttons



Switch Base Assembly



5 Channel Faceplate

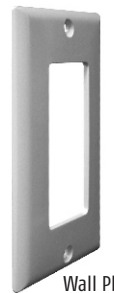

Wall Plate

## REPLACE STANDARD (BLANK) CHANNEL BUTTONS WITH PRINTED CHANNEL BUTTONS

1. Using a small flat blade screw driver, carefully separate the Switch Base Assembly from the Faceplate (as shown in figure 1).
2. Replace standard (blank) or temporary labeled Channel Button(s) with new printed Channel Button(s).
3. Attach new Channel Button Face Plate (as shown in figure 3 & 4).

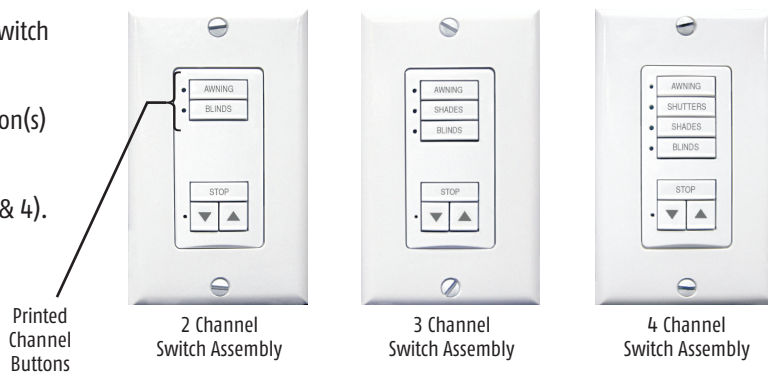

### FCC INFORMATION

This device complies with Part 15 of the FCC Results. Operation is subject to the following two conditions:

1. This device may not cause harmful interference, and
2. This device must accept any interference received, including that which may cause undesired operation.

NOTE: This equipment has been tested and found to comply with the limits for CLASS B digital device, pursuant to Part 15 of FCC Rules. These limits are designed to provide reasonable protection against harmful interference when the equipment is operated in a commercial environment. This equipment generates, uses and can radiate radio frequency energy and, if not installed and used in accordance with the instructions, may cause harmful interference to radio communications. However, there is no guarantee that interference will not occur in a particular installation. If this equipment does cause harmful interference to radio or television reception, which can be determined by turning the equipment off and on, the user is encouraged to try to correct the interference by one or more of the following measures: 1. Reorient or relocate the receiving antenna 2. Increase the separation between the equipment and receiver 3. Connect the equipment into an outlet on a circuit different from that to which receiver is connected 4. Consult the dealer or experienced radio/TV technician for help.

**WARNING: Changes or modifications not expressly approved by the manufacturer could void the user's authority to operate the equipment.**

SOMFY SYSTEMS, INC. reserves the right to change, update or improve this document without prior notice.