



**somfy**  
FOR BIOCLIMATIC FAÇADES

For more information about Somfy please contact us at:  
[somfyarchitecture@somfy.com](mailto:somfyarchitecture@somfy.com)

[www.bioclimatic-facades.com](http://www.bioclimatic-facades.com)

**PHILIPS**  
sense and simplicity

For more information:

[www.philips.com/lighting](http://www.philips.com/lighting)

# Maximum comfort Minimum energy

Somfy and Philips control light to optimize the working environment in buildings

**somfy**  
FOR BIOCLIMATIC FAÇADES

**PHILIPS**  
sense and simplicity

# Somfy and Philips control light in buildings to deliver greater comfort and energy savings

## Two global market leaders

**Somfy** controls incoming natural daylight, while **Philips** controls artificial indoor light. The two companies' complementary solutions allow optimal control of both.

Together, Somfy and Philips can substantially reduce energy usage: 75% of a building's energy consumption is used for lighting and heating/cooling.



Intelligent solutions from Somfy and Philips deliver maximum visual comfort and energy efficiency in buildings.

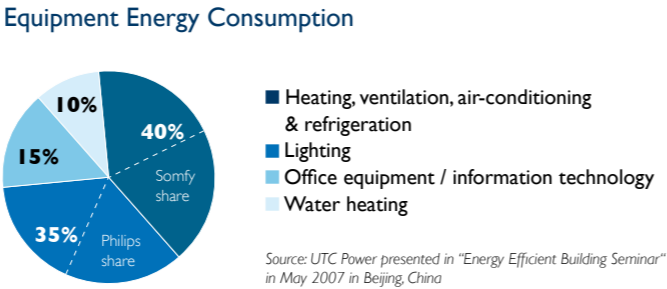

## The symbiosis between natural and artificial light management

As global market leaders in their respective fields, both Somfy and Philips seek to deliver user benefits through the efficient control of light. Their systems work naturally together: when the outside light is blocked to provide thermal comfort and glare control, the artificial light will automatically compensate the light levels and vice versa. This results in maximum comfort and the lowest possible energy consumption.

Systems from Somfy and Philips function interdependently without any undesired interference.

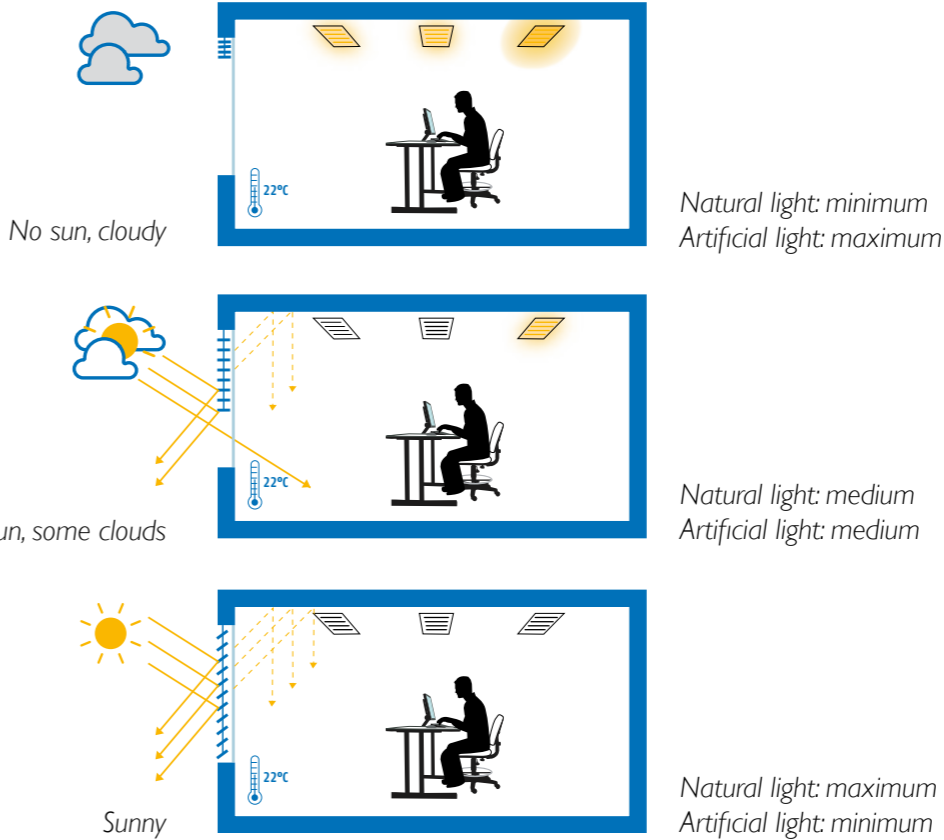

These examples show how both systems could interact



## somfy®

FOR BIOCLIMATIC FAÇADES

- Somfy has been the world leader in motors and controls for openings and closures in commercial and residential buildings for 40 years
- With the presence in 51 countries, every year hundreds of buildings are equipped with Somfy solutions
- Bioclimatic Façades is based around 3 unique areas of expertise in façade technologies: Dynamic Insulation™ - Natural light management - Natural ventilation

### Natural light management in buildings can:

- reduce the need for artificial light
- provide glare control, increase user comfort and productivity
- reduce the cooling demand and cooling load

	Annual savings with automated solar protection*		
	Interior blinds		Exterior shades
	Normal fabric	High reflective fabric	
Cooling demand (kWh)	15%	35%	50%
Cooling load (Watt)	20%	45%	50%

- reduce the energy consumption of cooling and heating systems resulting in reduced investment and maintenance costs
- (source: ES-SO Study Dec. 05)

\* The figures shown are average values. Savings will vary according to climate, shading device, building type, etc...

## PHILIPS

- Global market leader in lighting solutions since 1891
- Offers complete lighting solutions (controls, luminaires, lamps) for all lighting needs
- 65% of the world's top airports, 30% of commercial buildings and hospitals, one out of three cars and landmarks such as the Eiffel Tower; the Sydney Opera House and the Great Pyramids are lit by Philips
- Is externally recognized as a green leader by various global organizations

### Artificial light management in buildings can:

- realize substantial energy savings e.g through the use of controls:

	Presence detection	Daylight regulation	Presence detection + Daylight regulation
Energy saving	30%	30%	50%

- maximize comfort and ensure compliance with all relevant indoor norms such as EN 12464